

**ONE<sup>®</sup>**  
**FOR ALL**

English

Extra features

• **Mode Reassignment**

*How to set up two (or more) devices of the same type.*

page 2

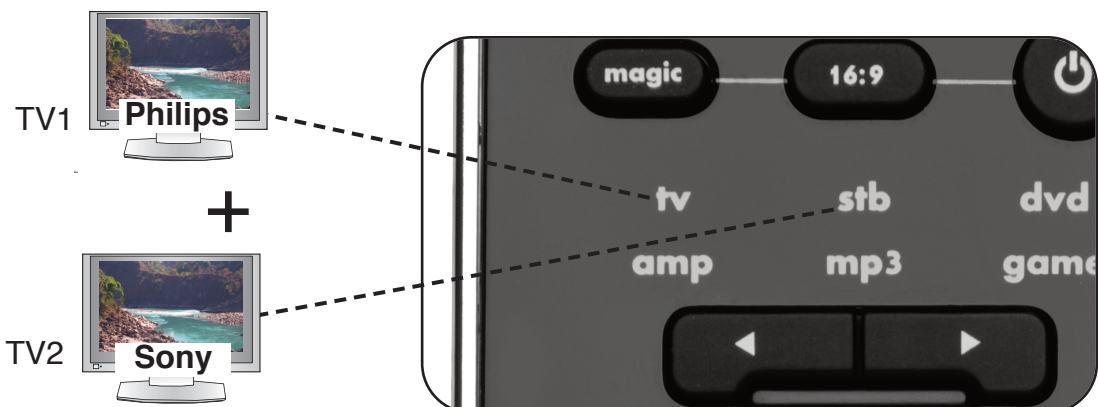

• **Key Magic<sup>®</sup>**

*Allows you to obtain functions from your LOST or BROKEN original remote control.*

page 3

Missing function after Set Up procedure



Obtain your Missing function through our Customer Service requesting a (5-digit) Key Magic<sup>®</sup> function code. Then, simply follow the procedure from page 3.

• **Macro**

*Allows you to send a sequence of commands with the press of a single key.*

page 4

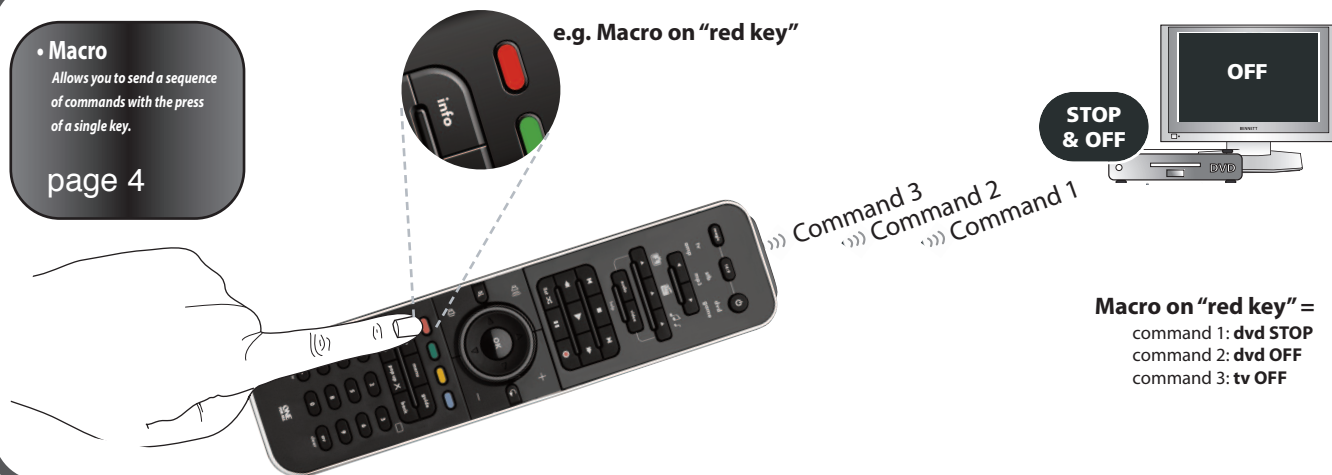

**Macro on "red key" =**  
command 1: **dvd STOP**  
command 2: **dvd OFF**  
command 3: **tv OFF**

• **What is my "Set Up Code again?"**

*Find out which code is currently set under each of the 6 device modes.*

page 5

My Code is?

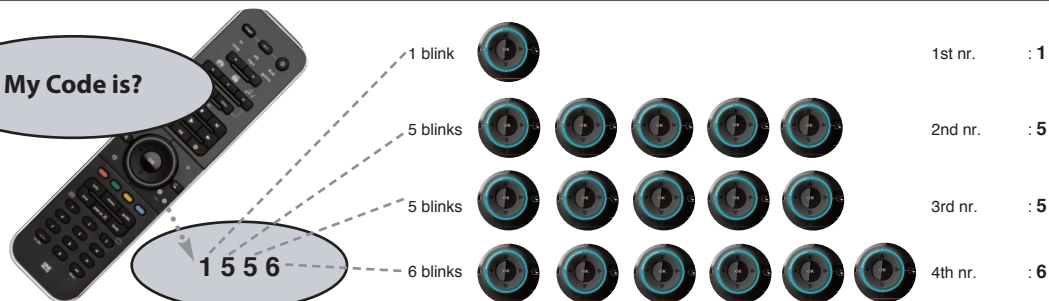

## Mode Reassignment

This feature gives you the possibility to program 2 (or more) of the same device types onto the ONE FOR ALL remote (e.g. two tv's).

In the following example you wish to set up an additional television. Therefore we will reassign (change) "stb" mode into "tv" mode.

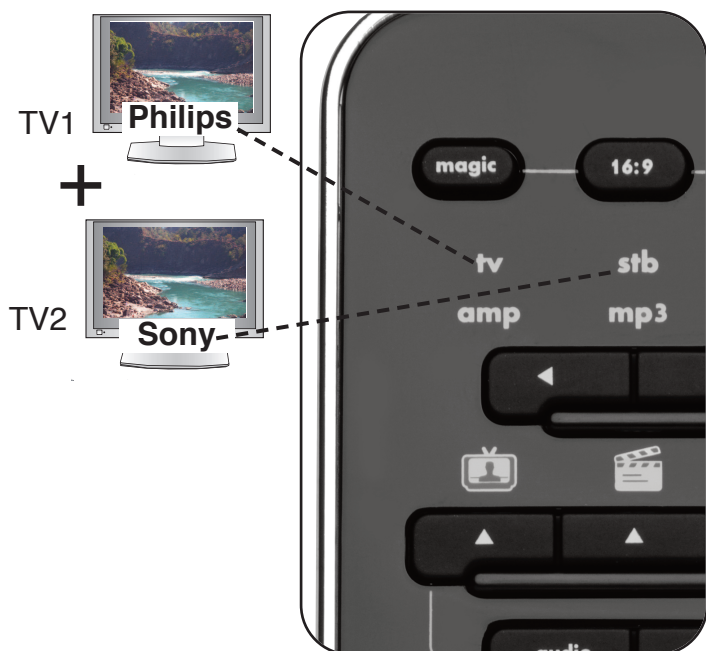

e.g. How to reassign "stb" into "tv" so you can control your second television as well:

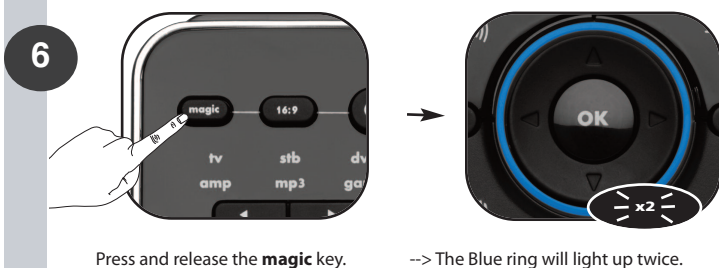
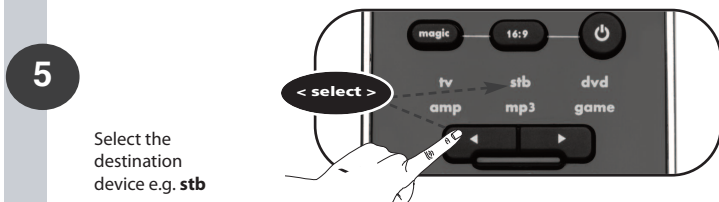
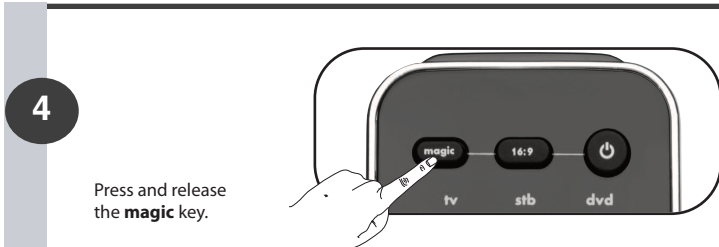
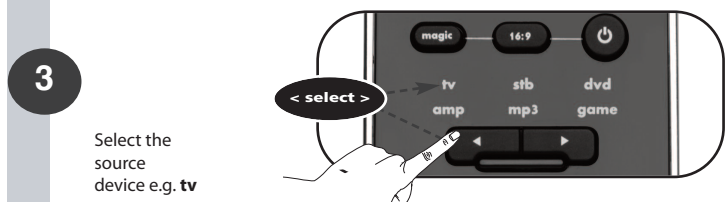
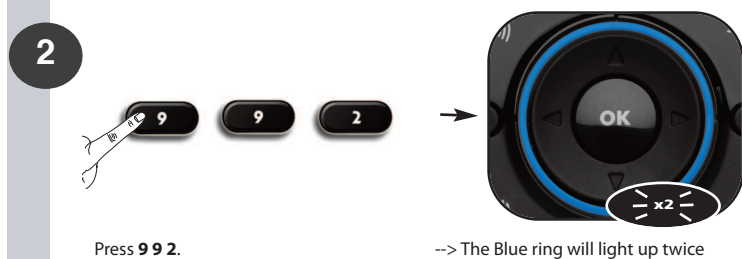
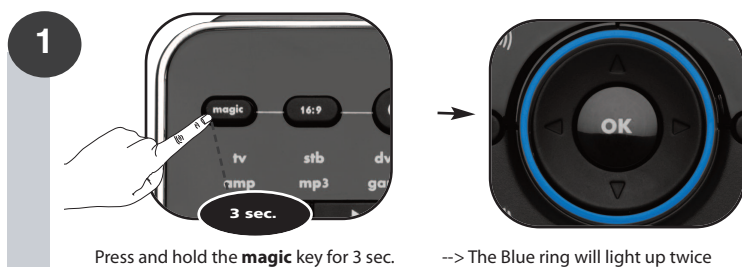

**Congratulations! You have successfully reassigned "stb" mode to become a second "tv" mode.**

**Now simply follow "ONE FOR ALL SimpleSet", "Direct Code Set Up" or the "Search Method" to program your television in stb mode.**

### How to reset a device mode to its original mode?

- 1) Press and hold the magic key for 3 sec. --> The Blue ring will light up twice.
- 2) Press 9 9 2.
- 3) Select the corresponding device mode you wish to reset to its original mode (e.g. select stb).
- 4) Press the MAGIC key twice. The Blue ring will light up twice.

## Key Magic®

Key Magic® is an exclusive ONE FOR ALL feature. The design of the ONE FOR ALL ensures that many functions of your original remote control can be operated - even those that do not have their own key on the ONE FOR ALL keypad. Frequently used functions can be assigned to a key of your choice using the Key Magic® feature of your ONE FOR ALL. In order to program a certain function with Key Magic® you need to know the corresponding function code. As the function codes vary with different types of devices, they cannot be found in the manual. You can request your function codes through our consumer service help-line or by letter, fax or e-mail.

### When you contact us please make sure to mention the following:

- The Current code you are using (see "What is my Set Up Code again?" on page xx).
- Device-type, Brand & Model-number of the corresponding device.
- Model-number of the original LOST or BROKEN remote control.
- How the function was labeled on your original remote control.

then;

Customer Service will provide you:

- A function-code (5-digit) for every requested function.

Once you obtain your function code(s) from customer service, programming the code is easy:

**Example: How to get the "I/II (mono/stereo)" function from your original LOST or BROKEN remote onto the "red key" on your ONE FOR ALL remote control.**



1

Select the source device e.g. tv

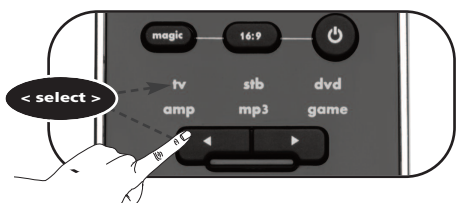

2

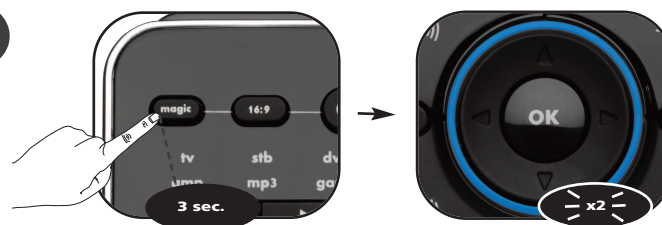

Press and hold the **magic** key for 3 sec. --> The Blue ring will light up twice

3

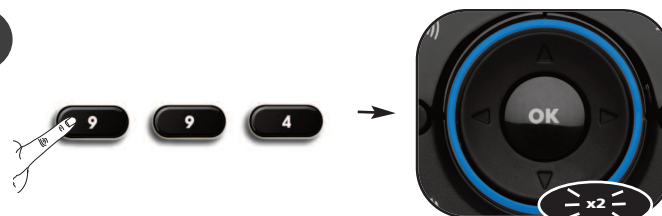

Press **9 9 4**. --> The Blue ring will light up twice

4

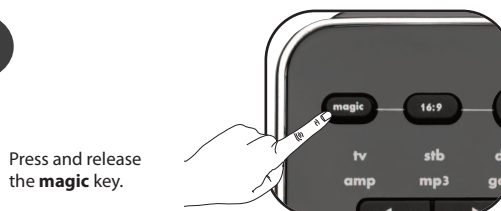

Press and release the **magic** key.

5



Enter the **5-digit function-code** provided by Customer Service. (e.g. 00123)

6

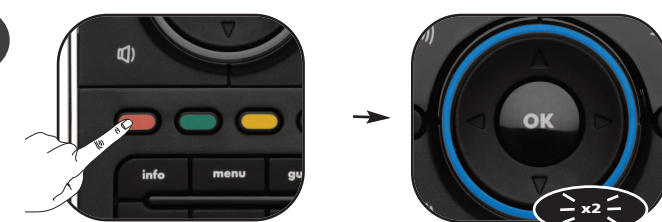

Press the **key to which the function will be assigned** (e.g. red key). --> The Blue ring will light up twice

**Congratulations! You have successfully programmed the "I/II (mono/streo)" function from your original remote control onto your ONE FOR ALL remote control. NOW whenever you press the "red key" (in tv mode) you will obtain the "I/II (mono/streo)" function.**

### How to reset a key to obtain its original function?

- 1) Select the corresponding device mode (e.g. tv).
- 2) Press and hold magic key for 3 sec. --> Blue ring will light up twice.
- 3) Press 9 9 4.
- 4) Press the corresponding key (e.g. red) twice.



## Macro

You can program your ONE FOR ALL to issue a sequence of commands at the press of one single key. Any sequence of commands you regularly use can be reduced to one key press for your convenience.

For example, you may want to create the following macro:

**1st command:**     **dvd --> STOP**  
**2nd command:**   **dvd --> OFF**  
**3rd command:**    **tv --> OFF**

To set up the Macro mentioned above on the e.g. "Red" key on your ONE FOR ALL:

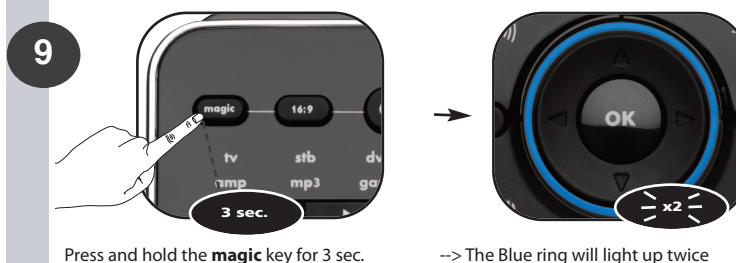
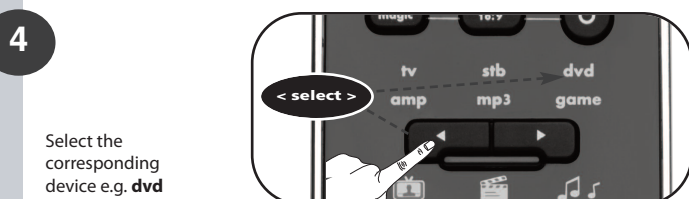
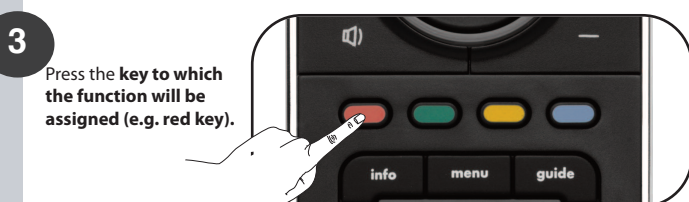
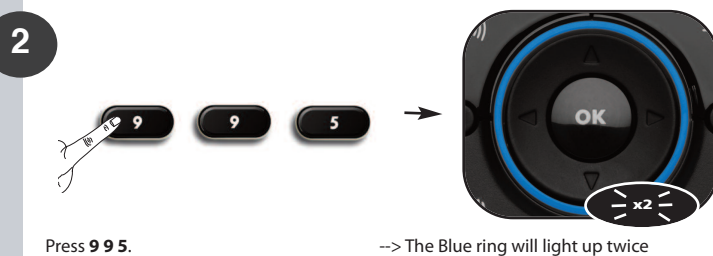
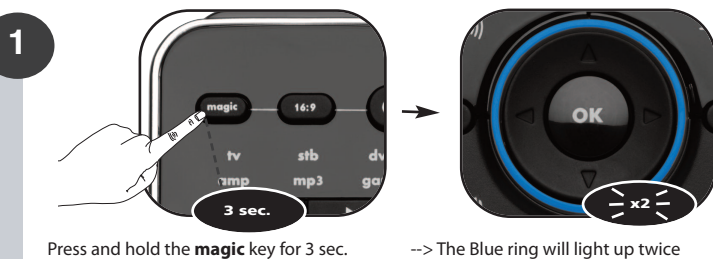

**Congratulations! You have successfully programmed a macro on the "red" key. NOW, when you press the red key: 1st: dvd will STOP, 2nd: dvd switches OFF, 3rd: tv switches OFF. The remote will do this in every device mode whenever you press the red key.**

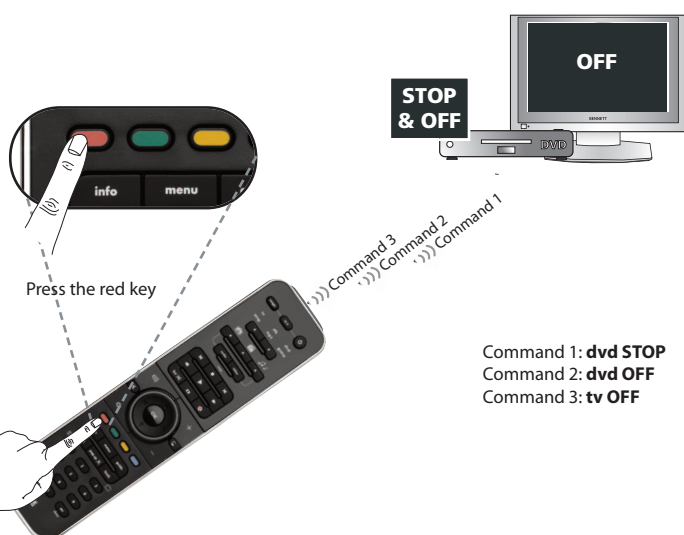

### How to reset the macro key to obtain its original function?

- 1) Press and hold magic key for 3 sec. --> The Blue ring will light up twice.
- 2) Press 9 9 5.
- 3) Press the corresponding macro key (e.g. the red key).
- 4) Press and hold magic key for 3 sec. --> The Blue ring will light up twice.

## What is my "Set Up Code" again?

You either set up your ONE FOR ALL by:

- ONE FOR ALL SimpleSet
- Direct Code Set Up
- Search Method

Example! How to find out which "Set Up Code" is currently set in tv mode:

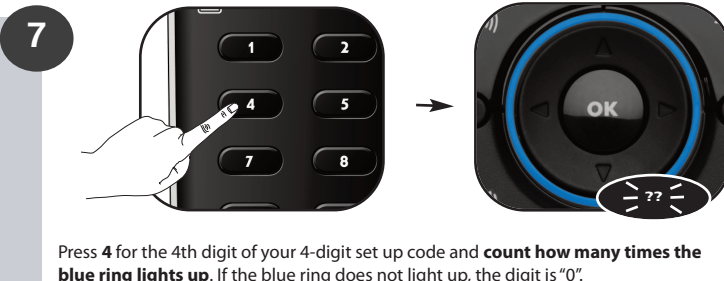
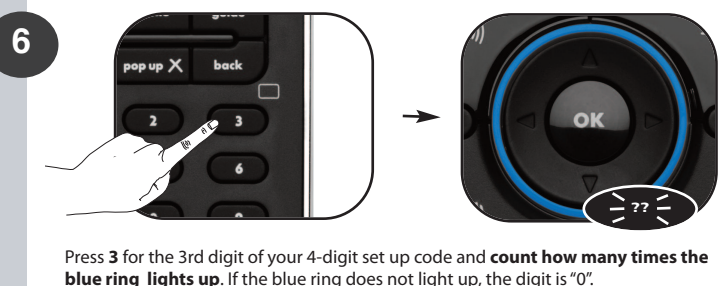
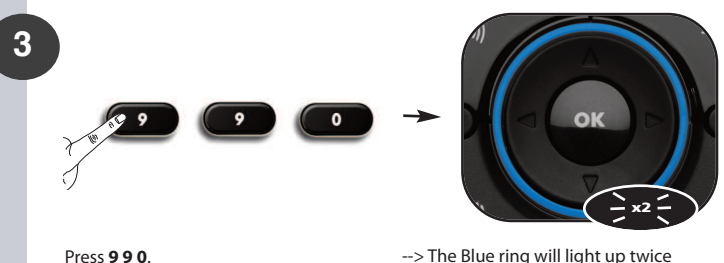
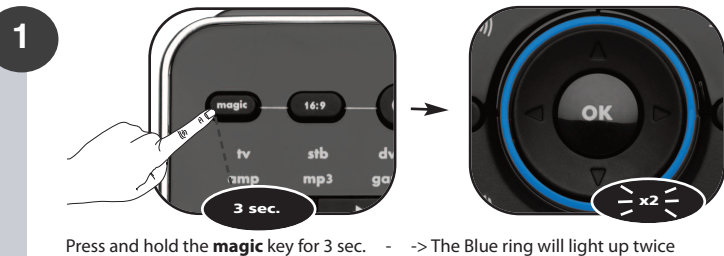

**Congratulations! You have successfully blinked out your current Set Up Code in tv mode.**

**Your "Set Up Codes":**

<input type="text"/>	_____
<input type="text"/>	_____
<input type="text"/>	_____
<input type="text"/>	_____
<input type="text"/>	_____
<input type="text"/>	_____
<input type="text"/>	_____

### Operational Reset

The Operational reset will erase all learned functions across all modes and some other programmed functions like Key Magic and Macros.

- 1) Press and hold the **magic** key for 3 sec. --> The Blue ring will light up twice.
- 2) Press **9 8 0**. The Blue ring will light up twice.